

3. Test the frother before use.

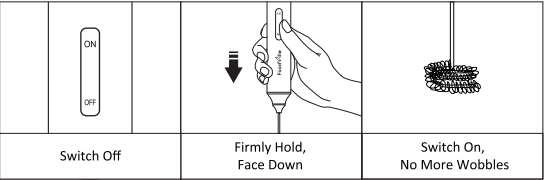

**Note:**  
Heavy duty whisk material leads to wobbling issues.

**How to Charge Your Frother?**

- 1. Charge your frother immediately when the indicator flashed red.
- 2. For fast charging, connect the wand to a charger using the supplied USB to USB Type C cable. Plug the charger into a wall outlet.
- 3. The red charging light means “Charging”, and the light will go out after a “Full Recharge”.

**Cleaning Tips**

- 1. Do not immerse the wand handle into water or any other liquids.
- 2. Remove the whisk head from the wand handle before cleaning.
- 3. Wash the whisk head in hot soapy water, then rinse under running water.
- 4. Wipe the whisk head and wand with a dry, clean cloth.
- 5. Turn the frother over and place on a flat surface to prevent water entering the wand.

**Helpful Tips**

- 1. Excessive operating time (≥ 25min) will affect motor and built-in battery performance.
- 2. Operating temperature should be no more than 60°C.
- 3. Keep out of reach of children.

**Technical Specifications**

Battery Type: 1200mAh Rechargeable 18650 Lithium-ion Battery  
Operating Time: 1 Hour (High Speed), 1.5 Hours (Medium or Low Speed)  
Charging Voltage: DC 3.7V, 2.5W  
Charging Current: Max. 0.5A  
Charging Time: 6 Hours

**FoodVille MF05  
Electric Milk Frother**

**Register the 2-Year Warranty Now**

- You can enjoy:**
- 1. While Amazon's return window is only 30 days, we extend it to 2 years after your warranty registration.
  - 2. While Amazon ask you to return the item first and then send the replacement. Instead, you can Email us directly to enjoy your replacement without a return.

**Manufacturer Warranty Registration Guide:**

- 1. Login Your Amazon Account.
- 2. Click “Your Orders” and find or search this FoodVille milk frother order.
- 3. Click the yellow button [Get product support](#) and then [Visit FoodVille support website](#) to register your warranty.
- 4. You will receive our registration confirmation within 24 hours.

**Box Contents**

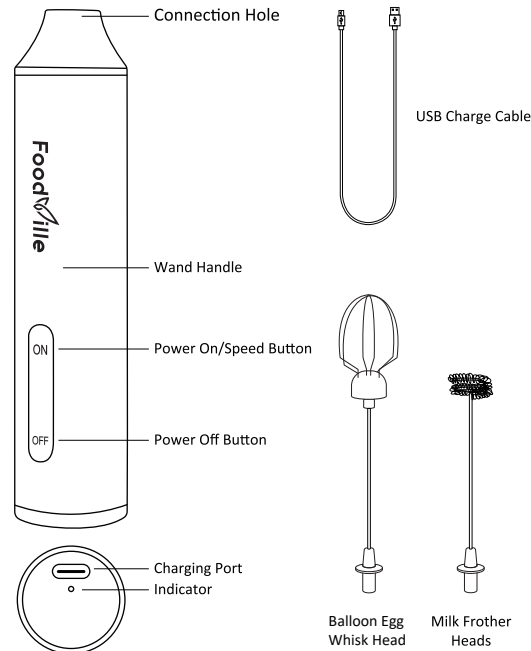

**How to Install the Whisk Head?**

- 1. Point the whisk head to the groove in the wand handle.
- 2. Insert it all the way to the end.

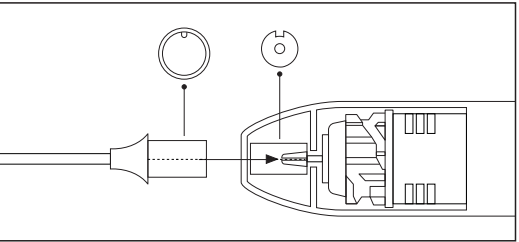

**Note:**  
To stop wobbling issues, make sure the whisk head is properly and deeply inserted into the connection hole. If wobbling persists, please do not hesitate to contact us for a replacement.

**How to Remove the Whisk Head?**

- 1. Firmly hold the top of the whisk and the bottom of the wand handle.
- 2. Use both hands to pull the whisk out in the opposite direction.
- 3. To avoid bending, do not grip the shaft to pull the whisk from the handle.

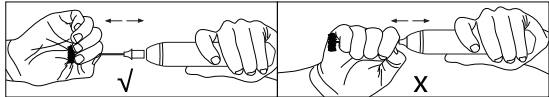

**How to Turn On, Turn Off and Change Speed?**

- 1. Press “ON” to turn on the frother.
- 2. Press this button again to increase speed. Press it a third time to back to low-speed level. The frother has two speed levels.
- 3. Press “OFF” to turn off the frother.

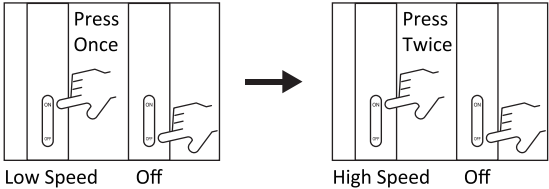

**Note:**  
Turn off the frother before removing it from your drink to avoid making a mess.

**How to Eliminate Wobbling Issues?**

- 1. Do not bend the shaft when connecting to the wand handle.
- 2. Be sure to insert the whisk into the drink/egg whites vertically.