

How to Eliminate Wobbling Issues?

- 1. Do not bend the shaft when connecting to the whisk head.
- 2. Always insert the head into the drink/egg whites vertically.
- 3. Test the device before operating it.

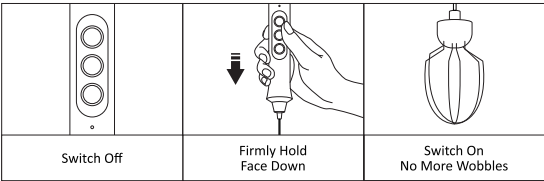

Note:
The wobbling issues are caused by heavy duty whisk head.

How to Charge Your Frothing Wand?

-Connect the charging stand to a compatible charger using a USB cable (included), and then place the wand on the stand.
-You can also connect the wand to a compatible charger directly using a USB cable (included) for charging.

Note:
The red indicator light means “Charging”, the green light indicates “Fully Charged”.

Cleaning Tips

- 1. Do not immerse the wand handle in water or any other liquids.
- 2. Remove the whisk and shaft from the wand handle before cleaning.
- 3. Clean the whisk head in hot soapy water and rinse it with running water.
- 4. Wipe the whisk head or wand with a dry, clean cloth.
- 5. Turn the device over and place on a flat surface to avoid water entering the wand.

Helpful Tips

- 1. Excessive operating time (≥ 5min) will affect motor and built-in battery performance.
- 2. Operating temperature should be no more than 60°C.
- 3. Keep out of reach of children.

Technical Specifications

Battery Type: 1800mAh Rechargeable 18650 Lithium-ion Battery
Operating Time: 1 Hour (High Speed), 1.5 Hours (Medium or Low Speed)
Charging Voltage: DC 3.7V, 2.5W
Charging Current: Max. 0.5A
Charging Time: 6 Hours

FoodVille MF09
Electric Milk Frother

Register the 2-Year Warranty Now

- You can enjoy:**
- 1. While Amazon's return window is only 30 days, we extend it to 2 years after your warranty registration.
 - 2. While Amazon ask you to return the item first and then send the replacement. Instead, you can Email us directly to enjoy your replacement without a return.

Manufacturer Warranty Registration Guide:

- 1. Login Your Amazon Account.
- 2. Click “Your Orders” and find or search this FoodVille milk frother order.
- 3. Click the yellow button [Get product support](#) and then [Visit FoodVille support website](#) to register your warranty.
- 4. You will receive our registration confirmation within 24 hours.

Box Contents

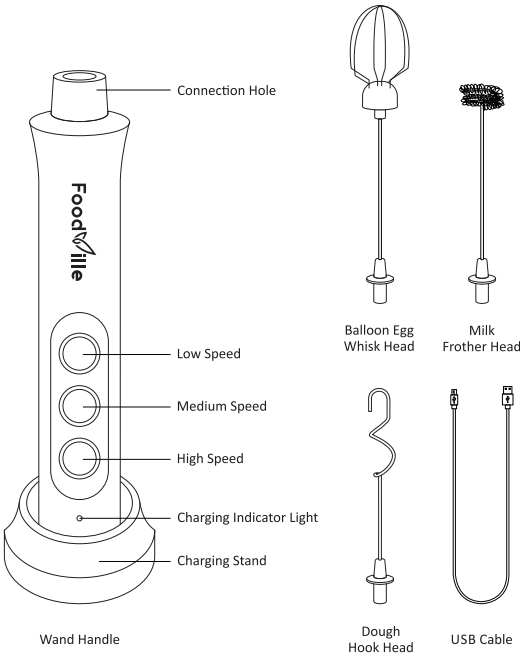

How to Install the Head?

- 1. Select the appropriate whisk head.
- 2. Align slots on the whisk head with built-in connecting bars of the wand handle.
- 3. Insert the whisk head into the connection hole properly.

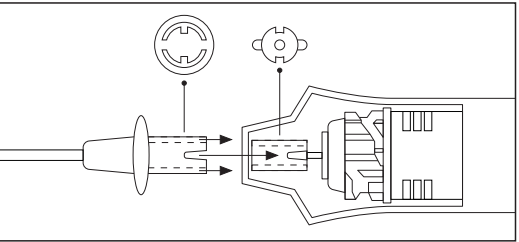

Note:
To stop a shaking appliance, please install the whisk head several times and try to deep insert it into the wand handle. If shaking persists, please do not hesitate to contact us for a replacement.

How to Remove the Head?

- 1. Firmly hold the head of the whisk and the bottom of the wand handle.
- 2. Pull out with your both hands together.
- 3. To avoid bending, do not hold the shaft to pull the whisk from the handle.

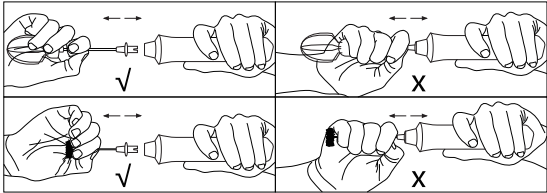

How to Turn On, Turn Off and Select a Speed Mode?

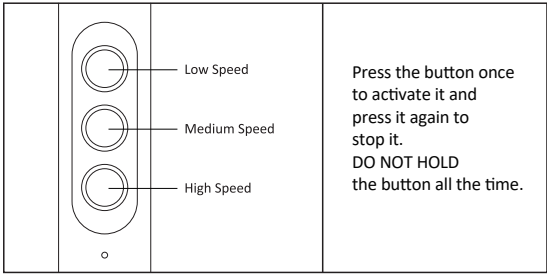

Note:
To avoid making a mess,
-make sure turn on the frother after putting it into your drink;
-always turn off the frother at first before removing it from your drink.