

How to Charge Your Frothing Wand?

- Connect the wand to a compatible charger directly by using a Type-C charging cable (included) for charging.
- You can also connect the wand to a compatible USB port directly by using a Type-C charging cable (included) for charging.

Note:

- 1.The red color charging mark means "Charging", the green charging mark indicates "Fully Charged".
- 2.The battery remaining data will be decreasing rapidly from 100 to 95 when you removing the charging cord from the main handle. That is normal as it was counted according to the voltage. It will be stable when using it a while.

How to Eliminate Wobbling Issues?

- 1.Usually this problem was caused the improper connection. You can remove and reinstall the attachment again to make sure it was fully connected with the main handle.
- 2.Please hold the handle vertically downward and use your hand power to fully squeeze the main handle to eliminate the shaking.
- 3.Please test another whisk head to confirm if it having the same issue. If so, it is the problem of the main handle. If other whisks working fine, that is the problem of the frother head only.
- 4.Do not bend the shaft when connecting to the whisk head.
- 5.Always insert the head into the drink/egg whites vertically.

4

Cleaning Tips

- 1.Do not immerse the wand handle in water or any other liquids.
- 2.Remove the whisk and shaft from the wand handle before cleaning.
- 3.Clean the whisk head in hot soapy water and rinse it with running water.
- 4.Wipe the whisk head or wand with a dry, clean cloth.
- 5.Turn the device over and place on a flat surface to avoid water entering the wand.

Helpful Tips

- 1.Excessive operating time (> 5min) will affect motor and built-in battery performance.
- 2.Operating temperature should be no more than 60°C.
- 3.Keep out of reach of children.

Technical Specifications

Battery Type: 1800mAh Rechargeable
18650 Lithium-ion Battery
Operating Time: 1 Hour to 3 Hours from speed level 9 to level 1.
Charging Voltage: DC 3.7V, 2.5W
Charging Current: Max. 0.5A
Charging Time: 6 Hours

5

FoodVille MF06 Electric Milk Frother

Register the 2-Year Warranty Now

You can enjoy:

- 1.While Amazon's return window is only 30 days, we extend it to 2 years after your warranty registration.
- 2.While Amazon ask you to return the item first and then send the replacement. Instead, you can contact the manufacturer directly to enjoy your replacement without a return.

Manufacturer Warranty Registration Guide:

1. Login Your Amazon Account.
2. Click "Your Orders" and find or search this FoodVille milk frother order.
3. Click the yellow button [Get Product Support](#) and then [Visit FoodVille support website](#) to register your warranty.
4. You will receive our registration confirmation within 24 hours.

Box Content

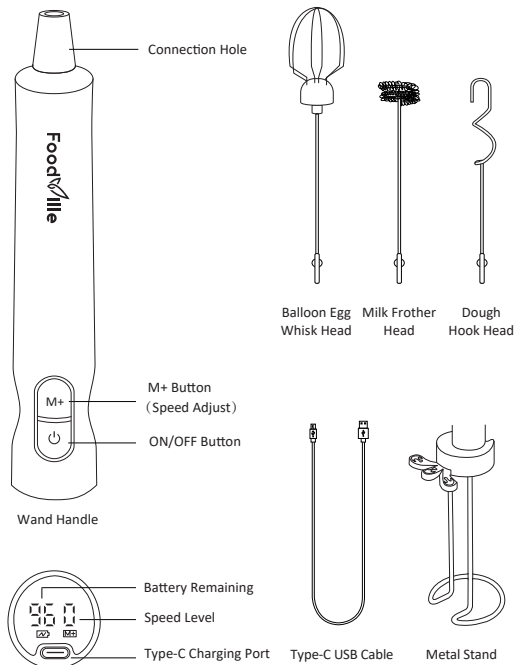

1

How to Install the Head?

- 1.Select the appropriate whisk head.
- 2.Align the connector on the whisk head with the built-in connecting slot of the wand handle.
- 3.Insert the whisk head into the connection hole properly until you hearing a CLICK sound.

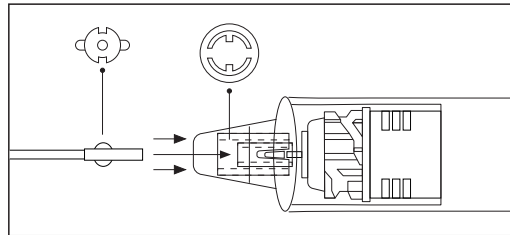

Note:

To stop a shaking appliance, please install the whisk head several times and try to deep insert it into the wand handle. If shaking persists, please do not hesitate to contact us for a replacement.

How to Remove the Head?

- 1.Firmly hold the head of the whisk and the bottom of the wand handle.
- 2.Pull out with your both hands together.
- 3.To avoid bending, do not hold the shaft to pull the whisk from the handle.

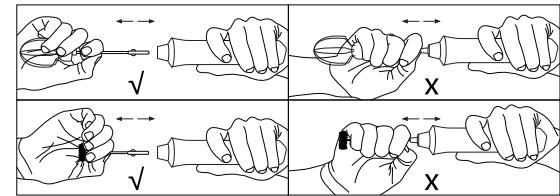

How to turn it on and adjust the speed?

- 1.Press any button (ON/OFF button or M+ button) once to turn the device on.
- 2.Press the M+ button to activate the device (1st level).
- 3.Press the M+ button again to enter the next speed level (Level 1-2-3-4-5-6-7-8-9-0).

How to turn it off?

- 1.To stop spinning, press the ON/OFF button once to stop spinning or Long Press the M+ button to stop spinning.
 - 2.Long Press the ON/OFF button to turn off the device.
 - 3.The device will be turned off automatically in 60 seconds without operation.
- *DO NOT HOLD the button all the time.

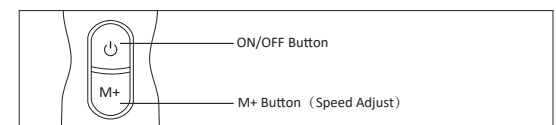

2

3